

GENERAL NOTES

- ALL WORK SHALL BE PERFORMED IN STRICT ACCORDANCE WITH THE REQUIREMENTS OF THE FOLLOWING CODES AND STANDARDS:
- ELECTRICAL CODE
 - BUILDING CODE
 - BUILDING RULES AND REGULATIONS.
 - LOCAL FIRE CODE AND FIRE DEPARTMENT REQUIREMENTS.
 - STATE ENERGY CODE
 - UTILITY COMPANY STANDARDS AND REQUIREMENTS.
 - OCCUPATIONAL SAFETY AND HEALTH ACT (OSHA)
 - AMERICAN DISABILITIES ACT (ADA)
 - AMERICAN UNDERWRITERS LABORATORIES, INC. (UL)
 - NATIONAL FIRE PROTECTION ASSOCIATION (NFPA 99)
 - AMERICAN INSTITUTE OF ARCHITECTS (AIA) DESIGN GUIDELINES
 - ALL LOCAL JURISDICTION DIRECTIVES AND REQUIREMENTS.
2. PROVIDE A COMPLETE OPERABLE SYSTEM IN A WORKMANLIKE MANNER. OUTLINE DESCRIPTION AND EQUIPMENT DO NOT LIMIT CONTRACTOR'S LIABILITY FOR THE INSTALLATION OF A COMPLETE OPERABLE SYSTEM.
3. ALL ELECTRICAL EQUIPMENT SHALL BE THE LATEST OF THE CURRENT YEAR IN DESIGN, MATERIAL AND WORKMANSHIP, AND SHALL BE THE TYPE OR MODEL CALLED FOR IN THESE DRAWINGS AND SPECIFICATIONS
4. CONTRACTOR TO BE RESPONSIBLE FOR REVIEWING THE FULL SET OF BID DOCUMENTS TO BE AWARE OF THE TOTAL SCOPE PRIOR TO SUBMITTING BID. ALL WORK SHOWN ON THE DRAWINGS NOT SPECIFICALLY CALLED OUT AS EXISTING SHALL BE CONSIDERED WORK TO BE PERFORMED UNDER THIS CONTRACT.
5. BIDDERS, BEFORE SUBMITTING A PROPOSAL, SHALL VISIT AND CAREFULLY EXAMINE THE SITE TO BECOME FAMILIAR WITH THE EXISTING CONDITIONS AND WITH THE DIFFICULTIES THAT WILL ATTEND THE EXECUTION OF THIS WORK. SUBMISSION OF A BID IMPLIES CONSTRUCTION OF EVIDENCE THAT SUCH EXAMINATION HAS BEEN MADE. LATER CLAIMS WILL NOT BE RECOGNIZED FOR EXTRA LABOR EQUIPMENT OR MATERIALS REQUIRED BECAUSE OF DIFFICULTIES ENCOUNTERED. NO ALLOWANCE WILL SUBSEQUENTLY BE MADE TO THE CONTRACTOR BY REASON OF ANY ERROR DUE TO THE CONTRACTOR'S NEGLIGENCE TO COMPLY WITH THIS REQUIREMENT. REPORT ANY DISCREPANCIES BETWEEN DRAWINGS AND FIELD CONDITIONS TO THE ENGINEER.
6. BEFORE COMMENCING WORK, THE CONTRACTOR SHALL FILE ALL REQUIRED CERTIFICATES OF INSURANCE WITH THE BUILDING DEPARTMENT, FIRE DEPARTMENT AND ALL OTHER GOVERNMENTAL AGENCIES. OBTAIN ALL REQUIRED PERMITS, TEST REPORTS, CERTIFICATIONS FOR T.C.O. AND C.O. AND PAY ALL FEES REQUIRED.
7. ALL NOTATIONS OF "SCALE" ARE INTENDED AS APPROXIMATIONS. THE CONTRACTOR SHALL BE RESPONSIBLE TO ASCERTAIN THE EXACT DIMENSIONS IN FIELD.
8. ELECTRICAL DRAWINGS ARE DIAGRAMMATIC, SIZES AND LOCATION OF EQUIPMENT AND WIRING ARE SHOWN TO SCALE WHERE POSSIBLE, BUT MAY BE DISTORTED FOR CLARITY ON THE DRAWINGS.
9. ELECTRICAL CONTRACTOR SHALL TAKE DELIVERY AND RESPONSIBILITY FOR ALL EQUIPMENT PRE-PURCHASED BY THE OWNER FOR THIS PROJECT. WORK SHALL INCLUDE RECEIVING EQUIPMENT AT STREET - SIDE MOVING IT TO INTERIM ON-SITE SECURE STORAGE LOCATION, PROTECTING EQUIPMENT FROM DAMAGE, MOVING THE EQUIPMENT FROM STORAGE TO ITS FINAL POSITION, SETTING IN PLACE, AND COMPLETION OF ALL INSTALLATION, TESTING AND COMMISSIONING PROCEDURES REQUIRED FOR APPLICABLE EQUIPMENT.
10. UPON COMPLETION OF ALL ELECTRICAL WORK, ELECTRICAL CONTRACTOR SHALL ADJUST AND TEST ALL CIRCUITS, WIRING DEVICES, LIGHTING FIXTURES, MOTORS AND ANY OTHER ELECTRICAL ITEMS INSTALLED. ANY DEFECTIVE ITEMS SHALL BE IMMEDIATELY REPAIRED OR REPLACED WITH NEW EQUIPMENT OR MATERIALS AND THAT PORTION OF THE SYSTEM SHALL BE RE-TESTED. ALL SUCH REMEDIAL WORK SHALL BE PROVIDED AT NO ADDITIONAL COST TO THE OWNER.
11. UPON COMPLETION OF WORK, ELECTRICAL CONTRACTOR SHALL BALANCE ALL PANELBOARDS AFFECTED TO WITHIN 10% DEVIATION BETWEEN PHASES.
12. REMOVE ALL DEBRIS RESULTING FROM REMOVAL AND/OR INSTALLATION OF ELECTRICAL WORK FROM THE PREMISES. REMOVAL OF DEBRIS SHALL BE COORDINATED WITH BUILDING MANAGEMENT. DISPOSAL WORK SHALL BE IN COMPLIANCE WITH THE REQUIREMENTS OF THE BUILDING CODE AND WITH ALL STATE AND FEDERAL REGULATIONS
13. UNLESS OTHERWISE NOTED, ELECTRICAL EQUIPMENT INCLUDING BUT NOT LIMITED TO PULL BOXES, JUNCTION BOXES, WIRING DEVICES, PANELBOARDS, LOW VOLTAGE SYSTEMS DEVICES, ETC WHERE INDICATED ON DRAWINGS, SHALL BE CONSIDERED SHOWN AT THEIR APPROXIMATE LOCATION. THE CONTRACTOR SHALL LOCATE THESE ITEMS AS FIELD CONDITIONS DICTATE AND AS APPROVED BY THE ARCHITECT AND/OR ENGINEER.
14. ALL CONDUIT RUNS, WHEN SHOWN ON THE DRAWINGS, ARE SHOWN DIAGRAMMATICALLY TO OUTLINE THE GENERAL ROUTING OF MAJOR FEEDERS AND BRANCH WIRING. IT IS NOT WITHIN THE SCOPE OF THESE DRAWINGS TO SHOW ALL NECESSARY BENDS, OFFSETS, PULL BOXES, JUNCTION BOXES AND OBSTRUCTIONS. IT SHALL BE THE RESPONSIBILITY OF THE CONTRACTOR TO INSTALL HIS WORK TO CONFORM TO THE REQUIREMENTS OF THE ELECTRICAL CODE AND TO PRESERVE HEADROOM.
15. ADDITIONAL PULL BOXES, JUNCTION BOXES AND WIRE TROUGHS NOT SHOWN ON DRAWINGS SHALL BE PROVIDED WHERE REQUIRED BY APPLICABLE CODE REQUIREMENTS OR WHERE CALLED FOR BY FIELD CONDITIONS. PULL AND JUNCTION BOXES SHALL BE SURFACE TYPE IN UNFINISHED SPACES AND FLUSH TYPE IN FINISHED SPACES. PROVIDE COVERS FOR ALL JUNCTION BOXES, PULL BOXES AND WIRE TROUGHS. COVERS SHALL BE ACCESSIBLE.
16. CONDUIT RUNS SHALL CLEAR ALL ARCHITECTURAL FEATURES (DOORS, WINDOWS, ETC.) AND STRUCTURAL MEMBERS. CONDUIT INSTALLATION SHALL ALSO BE MADE TO AVOID INTERFERENCE WITH PIPES, DUCTS, OR OTHER EQUIPMENT CORRESPONDING TO OTHER TRADES, INCLUDING BUT NOT LIMITED TO MECHANICAL PLUMBING AND FIRE PROTECTION. SHALL ANY OF THIS ELEMENTS PREVENT THE INSTALLATION OF RACEWAY AS DELINEATED ON THE CONTRACT DOCUMENTS, DEVIATION MUST BE APPROVED BY THE ENGINEER PRIOR TO INSTALLATION. ANY DEVIATION DUE TO FIELD CONDITIONS SHALL NOT REPRESENT AN ADDITIONAL COST TO OWNER.
17. ALL CONDUIT RUNS SHALL BE CONCEALED WITHIN WALLS OR CEILING. EXPOSED CONDUITS AND BOXES, WHEN REQUIRED, SHALL BE PAINTED. PAINTING SHALL BE SUBJECT TO A FINE COAT OF A FINISHED COAT. COLOR AS SELECTED BY ARCHITECT OR TO MATCH SURROUNDING SURFACES. PAINTING PAINTING WILL BE ACCEPTED AS A PRIME COAT.
18. MINIMUM SIZE OF CONDUITS SHALL BE 3/4", UNLESS OTHERWISE NOTED.
19. INSTALL PULL WIRES IN EMPTY RACEWAYS. USE POLYPROPYLENE OR MONOFILAMENT PLASTIC LINE WITH NOT LESS THAN 200-LB (90-KG) TENSILE STRENGTH. LEAVE AT LEAST 12 INCHES (300 MM) OF SLACK AT EACH END OF PULL WIRE
20. PROVIDE PIPE SLEEVES WHERE CONDUITS ARE ROUTED THROUGH FOUNDATION WALLS, SLABS AND FIRE RATED PARTITIONS. PIPE SLEEVES SHALL BE GROUTED. SEALANT SHALL BE APPLIED AROUND THE CONDUIT IN THE SLEEVE IN ORDER TO PREVENT INGRESS OF MOISTURE. WALL AND SLAB PENETRATIONS SHALL BE COMPLETELY WATERPROOFED AND/OR FIRE PROOFED.
21. ALL OPENINGS BETWEEN FLOORS, THROUGH RATED FIRE AND SMOKE WALLS, CREATED BY THE CONTRACTOR FOR CABLE OR CONDUIT PASS THROUGH SHALL BE SEALED WITH A FIRE STOPPING MATERIAL. FIRE STOPPING MATERIAL AND ITS APPLICATION SHALL BE ACCOMPLISHED IN SUCH A MANNER THAT IS ACCEPTABLE TO THE LOCAL FIRE AND BUILDING AUTHORITIES HAVING JURISDICTION OVER THIS WORK. ANY OPENINGS CREATED BY OR FOR THE CONTRACTOR AND LEFT UNUSED SHALL ALSO BE SEALED AS PART OF THIS WORK. REFER TO ARCHITECTURAL DRAWINGS FOR FIRE RATING OF WALLS AND SLABS.
22. IN UNFINISHED SPACES OF THE BUILDING SUCH AS FAN ROOMS, PIPE SPACES, ETC., LOCATIONS OF CONDUIT AND OUTLETS ARE APPROXIMATE AND SHALL CLEAR ALL OTHER WORK. IN FINISHED SPACES, ALL OUTLETS MUST BE UNOBTURATED AND EXTENDED AS DIRECTED TO CLEAR ANY INTERFERENCE WITH FIXTURES, PIPING EQUIPMENT, ETC.

23. SUPPORT ALL ELECTRICAL EQUIPMENT AND CONDUIT FROM BUILDING STRUCTURE AND/OR FRAMING IN AN APPROVED MANNER. WHERE OVERHEAD CONSTRUCTION DOES NOT PERMIT FASTENING OF SUPPORTS FOR EQUIPMENT, FURNISH ADDITIONAL FRAMING. ALL ELECTRICAL EQUIPMENT AND RACEWAY SHALL BE SUSPENDED FROM SUPPLEMENTAL SLOTTED CHANNEL FRAME. ALL SUCH MOUNTS, DEVICES, FASTENERS SHALL BE OF SUFFICIENT THICKNESS TO CARRY THE LOAD SUSPENDED. CONTRACTOR SHALL BE RESPONSIBLE FOR PROVIDING ANY ADDITIONAL SUPPLEMENTAL STEEL REQUIRED TO SUPPORT THE EQUIPMENT OR DEVICES.
24. PROVIDE OUTLET BOXES AND ENCLOSURES APPROPRIATE FOR THE PURPOSE AT EACH LOCATION WHERE THE DRAWINGS REQUIRE THE INSTALLATION OF ELECTRICAL DEVICES OR ELECTRICAL EQUIPMENT.
25. ALL EXPOSED NONCURRENT-CARRYING METAL PARTS OF ELECTRICAL EQUIPMENT AND RACEWAYS SHALL BE GROUNDED, FOR FEEDERS AND/OR BRANCH CIRCUITS WHERE GROUNDING CONDUCTOR IS NOT PROVIDED, METAL RACEWAYS AND METAL ENCLOSURES FOR CONDUCTORS SHALL BE TIGHTLY JOINED TO CREATE A CONTINUOUS ELECTRIC CIRCUIT AND SO ASSURE A PROPERLY GROUNDED SYSTEM. FITTINGS FOR JOINTS AND TERMINATIONS SHALL BE LISTED FOR GROUNDING INSTALLATION. PROVIDE BONDING JUMPERS WITH APPROVED FITTINGS OF SIZE REQUIRED FOR EQUIPMENT GROUNDING. THE CONTRACTOR SHALL ENSURE CONTINUITY OF THE GROUNDING CIRCUIT FROM THE SUPPLYING PANELBOARD GROUNDING BUS TO THE LOAD GROUND TERMINAL.
26. UNLESS OTHERWISE NOTED, CONDUCTORS FOR POWER AND LIGHTING CIRCUITS SHALL BE OF TYPE THHN/THWN AND MINIMUM SIZE SHALL BE #12 AWG. CONDUCTORS #10 AWG AND SMALLER SHALL BE COPPER, SOLID OR STRANDED; #8 AWG AND LARGER SHALL BE COPPER, STRANDED, TYPE.
27. BRANCH CIRCUIT CONDUCTORS SHALL BE INCREASED IN SIZE TO COMPENSATE FOR VOLTAGE DROP AS FOLLOWS:
- A. FOR CIRCUITS RATED AT 120V, 20A THAT RUNS OVER 100'-0", USE No. 10 AWG WIRE SIZE
- B. FOR CIRCUITS RATED AT 277V, 20A THAT RUNS OVER 200'-0", USE No. 10 AWG WIRE SIZE
28. ALL CIRCUITS FEEDING COMPUTERS, DIMMING BALLAST, DIMMING SYSTEMS AND OTHER NONLINEAR LOADS SHALL HAVE A DEDICATED NEUTRAL AND GROUNDING CONDUCTOR.
29. ELECTRICAL DRAWINGS INDICATE CIRCUIT NUMBERS (#) FOR RECEPTACLES, LIGHTING FIXTURES AND OTHER EQUIPMENT FEEDS. UNLESS OTHERWISE NOTED PROVIDE #12, #1#12 IN 3/4" CONDUIT TO 15A OR 20A CIRCUIT BREAKERS IN PANELS INDICATED. CIRCUIT NUMBERS (#) NOTED ON PLANS ARE INTENDED AS A GUIDE. FINAL NUMBERING SYSTEM TO BE NOTED ON AS-BUILT DRAWINGS AND ON TYPED PANELBOARD DIRECTORY CARDS.
30. LOW VOLTAGE WIRING SHALL NOT BE PERMITTED IN THE SAME RACEWAY AS POWER WIRING.
31. ALL GROUND WIRES SHALL BE INSTALLED IN CONDUIT.
32. FURNISH AND INSTALL WIRING FOR EQUIPMENT FURNISHED BY OTHERS, AS SHOWN ON ARCHITECTURAL, HVAC, PLUMBING AND/OR ELECTRICAL DRAWINGS. COORDINATE WITH OTHER TRADES FOR DETAILS OF INSTALLATION AND WIRING REQUIREMENTS. THE TERM "WIRING" AS USED HEREIN SHALL INCLUDE FURNISHING AND INSTALLING CONDUIT, WIRES, JUNCTION/OUTLET BOXES, DISCONNECTS, OVERCURRENT PROTECTION DEVICES AND FINAL CONNECTIONS. COORDINATE FINAL CONDUCTOR SIZES, QUANTITIES, VOLTAGE REQUIREMENTS, AND OVERCURRENT DEVICE AND OUTLET RATINGS WITH ACTUAL EQUIPMENT TO BE FURNISHED TO THE SITE PRIOR TO FINALIZING WIRING INSTALLATION. MINOR ADJUSTMENTS TO WIRING REQUIREMENTS NECESSARY TO ACCOMMODATE ACTUAL FURNISHED EQUIPMENT SHALL BE PROVIDED AT NO ADDITIONAL COST TO OWNER.
33. FURNISH AND INSTALL ALL COPPER MATERIALS INCLUDING BUT NOT LIMITED TO LUGS, COPPER BUS DETAILS/LUGS KITS, BUS BAR EXTENSIONS, ETC. REQUIRED FOR OVER SIZED FEEDERS AND/OR REQUIRED TO ACCEPT INCOMING AND OUTGOING CABLES TO COMPLETE CONTRACT WORK. ALSO PROVIDE LABOR AND MATERIALS REQUIRED TO MODIFY EXISTING OR NEW EQUIPMENT INCLUDING ENCLOSURE MODIFICATIONS. CONTRACTOR TO PROVIDE ALL REQUIRED ELECTRICAL FINAL CONNECTIONS.
34. VERIFY LOCATIONS OF ALL ELECTRICAL EQUIPMENT WITH ARCHITECTURAL DRAWINGS OR INTERIOR DETAILS. IN CENTERING OUTLETS AND LOCATING BOXES OR OUTLETS ALLOW FOR OVERHEAD PIPES, DUCTS, MECHANICAL EQUIPMENT, VARIATIONS IN FIREPROOFING AND PLASTERING, WINDOW AND DOOR TRIM, PANELING, HUNG CEILING, ETC., AND CORRECT ANY INACCURACY RESULTING FROM FAILURE TO DO SO WITHOUT EXPENSE TO OWNER.
35. REFER TO ARCHITECTURAL DRAWINGS FOR EXACT LOCATIONS OF WIRING DEVICES SUCH AS RECEPTACLES, LIGHTING SWITCHES, DIMMERS, DATA/TELEPHONE OUTLETS, ETC.
36. VERIFY SWITCHES, DIMMERS, RECEPTACLES AND COVER PLATES FINISHES WITH THE ARCHITECT AND/OR OWNER REPRESENTATIVE BEFORE PURCHASING AND INSTALLATION OF SUCH DEVICES.
37. WHERE MULTIPLE SWITCHES AND RECEPTACLES ARE INDICATED AT THE SAME LOCATION, THEY SHALL BE GANGED TOGETHER AND MOUNTED BEHIND A COMMON FACE PLATE UNLESS POWERED FROM AN EMERGENCY POWER SOURCE. PROVIDE SEPARATE OUTLET BOXES FOR NORMAL AND EMERGENCY CIRCUITS
38. PROVIDE GROUND FAULT CIRCUIT INTERRUPTER FOR EACH RECEPTACLE LOCATED WITHIN 6'-0" OF WATER OR LIQUIDS AND FOR OUTDOORS RECEPTACLES WHETHER INDICATED ON DRAWINGS OR NOT.
39. MOUNTING HEIGHTS OF EQUIPMENT AND DEVICES SHALL BE COORDINATED WITH ARCHITECT. UTILIZE THE FOLLOWING MOUNTING HEIGHTS UNLESS OTHERWISE NOTED OR DIRECTED BY ARCHITECT (ALL DIMENSIONS TO CENTERLINE OF BOX U.O.N.):
- A. RECEPTACLES (WALL MOUNTED) - 18" AFF
- B. RECEPTACLES (COUNTERTOPS) - NO MORE THAN 20" ABOVE THE COUNTERTOP
- C. VOICE/DATA OUTLETS - 18" AFF
- D. WALL MOUNTED TELEPHONES - 48" AFF
- E. LIGHTING SWITCHES AND CONTROLS - 48" AFF
- F. PANELBOARDS AND CABINETS - 78" TO TOP OF ENCLOSURE
- G. NURSE CALL DEVICES - 48" AFF
- H. MANUAL PULL STATIONS - 48" AFF
- I. FIRE ALARM AUDIO/VISUAL AND STROBE UNITS - 80" AFF OR 6" BELOW CEILING, WHICHEVER IS LOWER
40. ALL ELECTRICAL EQUIPMENT AND ACCESSORIES INSTALLED OUTDOOR OR EXPOSED TO WEATHER SHALL HAVE NEMA 3R ENCLOSURES AND SHALL BE TIGHTLY GASKETED FOR A COMPLETE RAIN TIGHT INSTALLATION. ALL BUILDING EXTERIOR MOUNTED RECEPTACLES SHALL BE GFI RATED AND MOUNTED IN WEATHERPROOF ENCLOSURE.
41. THE AREA ABOVE THE ELECTRICAL EQUIPMENT SUCH AS DISTRIBUTION BOARDS, PANELBOARDS, TRANSFORMERS, ETC., SHALL BE DEDICATED FOR ELECTRICAL INSTALLATION AND SHALL BE CLEAR FROM WORK OF OTHER TRADES (PIPING, DUCTS, ETC.).
43. PROVIDE AND/OR REVISE THE PANEL DIRECTORY OF EACH AND EVERY NEW AND/OR EXISTING PANELBOARD AFFECTED BY THIS ELECTRICAL WORK.
44. PROVIDE BLANK COVERS PLATES OVER ALL UNUSED OPENINGS IN NEW AND/OR EXISTING PANELBOARDS.

45. SHORT CIRCUIT RATING OF ELECTRICAL EQUIPMENT (CIRCUIT BREAKERS, FUSES, DISCONNECT SWITCHES, PANELBOARDS, ETC.) SHALL MEET OR EXCEED THE AVAILABLE FAULT CURRENT AT THEIR POINT OF CONNECTION AS REQUIRED FOR A FULLY RATED SYSTEM.
46. PROVIDE UNFUSED DISCONNECT SWITCHES FOR ALL MECHANICAL EQUIPMENT UNLESS OTHERWISE NOTED ON CONSTRUCTION DOCUMENTS.
47. THE MINIMUM RATING OF DISCONNECT SWITCHES SHALL BE EQUAL TO OR GREATER THAN THE RATING OF THE PROTECTIVE DEVICES ON THE SUPPLY SIDE OF THE DISCONNECT SWITCH. MINIMUM DISCONNECT SWITCH SIZE IS 30 AMPERES.
48. ALL EQUIPMENT SHALL HAVE COPPER CURRENT CARRYING PARTS INCLUDING GROUND BUS AND TERMINALS. ALUMINUM SHALL NOT BE PERMITTED.
49. ARCHITECTURAL FEATURES AS WELL AS OTHER TRADES EQUIPMENT SHOWN ON ELECTRICAL DRAWINGS ARE FOR BACKGROUND INFORMATION ONLY. COORDINATE WITH OTHER TRADES TO DETERMINE THE EXACT LOCATION OF FANS, A/C UNITS, MOTORS, PUMPS, EQUIPMENT TERMINAL BOXES, AND OTHER EQUIPMENT TO BE INSTALLED BY OTHER TRADES BEFORE CONDUIT WORK IS STARTED.
50. FOR EXACT LOCATION OF LIGHT FIXTURES, LIGHTING FIXTURE SCHEDULE AND LIGHTING SYMBOLS REFER TO ARCHITECTURAL AND/OR LIGHTING CONSULTANT DRAWINGS. INFORMATION SHOWN IN ELECTRICAL DRAWINGS IS FOR REFERENCE ONLY. FINAL LIGHTING APPROVAL BY ARCHITECT.
51. MOUNTING ACCESSORIES FOR RECESSED LIGHTING FIXTURES SHALL BE APPROPRIATE TO MEET THE REQUIREMENTS OF THE CEILING CONSTRUCTION. REFER TO ARCHITECTURAL DRAWINGS FOR CEILING TYPE SCHEDULE.
52. PENDANT MOUNTED FIXTURES IN AREAS WITH NO HUNG CEILING SHOULD BE INSTALLED AFTER DUCTWORK AND PIPING HAVE BEEN INSTALLED. COORDINATE MOUNTING HEIGHT AND LOCATION OF LIGHTING FIXTURES TO CLEAR MECHANICAL, ELECTRICAL, FIRE PROTECTION AND PLUMBING EQUIPMENT AND PIPING.
53. CONTRACTOR TO BE RESPONSIBLE FOR ALL PENETRATIONS, CORE DRILLING, SEALING, WATERPROOFING, CUTTING, PATCHING, PAINTING AND RESTORATION FOR THE COMPLETE CONTRACT WORK INDICATED. ALL RESTORATION WORK PERFORMED BY THIS CONTRACTOR SHALL RESTORE DISTURBED SURFACES TO ACCURATELY MATCH ALL SURROUNDING CONSTRUCTION USING THE SAME MATERIAL, WORKMANSHIP AND FINISH AS EXISTING SURFACES.
54. CONTRACTOR TO PROVIDE LABOR AND MATERIALS REQUIRED FOR THE INSTALLATION AND MAINTENANCE OF TEMPORARY LIGHTING AND REQUIRED POWER SOURCES.
55. INVESTIGATE EACH SPACE THROUGH WHICH EQUIPMENT MUST BE MOVED. WHERE NECESSARY, EQUIPMENT SHALL BE SHIPPED FROM MANUFACTURER IN SECTIONS OF SIZE SUITABLE FOR MOVING THROUGH AVAILABLE RESTRICTIVE SPACES. ASCERTAIN FROM THE HOSPITAL AT WHAT TIMES OF DAY EQUIPMENT MAY BE MOVED THROUGH THE AREAS.
56. MAINTAIN CONTINUOUS SERVICE ON FEEDERS SERVING THE AREAS AFFECTED DURING ALL THE PERIOD THE AREA IS UNDER CONSTRUCTION. NO OUTAGES WILL BE PERMITTED IN THESE AREAS DUE TO THE CONSTRUCTION PHASE. ALL WORK REQUIRING TEMPORARY SHUTDOWN SHALL BE PERFORMED AT NO ADDITIONAL COST TO THE OWNER. ANY REQUEST FOR SHUTDOWNS SHOULD BE BROUGHT TO THE ATTENTION OF OWNER'S REPRESENTATIVE AND BUILDING OPERATING PERSONNEL AND IT MUST BE NOTIFIED 72 (SEVENTY-TWO) HOURS IN ADVANCE. WORK SHALL NOT BE PERFORMED WITHOUT WRITTEN APPROVAL.
57. ALL WORK REQUIRING ELECTRICAL SHUTDOWN WHICH WILL AFFECT OTHER FLOORS OF THE BUILDING OR EVEN AFFECT THE NORMAL CONTINUATION OF CONSTRUCTION WORK ON THESE & OTHER FLOORS, CONTRACTOR TO PROVIDE A TEMPORARY PROBABLE EMERGENCY GENERATOR, AND SHALL NOT DISTURB CONTINUITY OF ELECTRICAL SERVICE TO THE AFFECTED FLOORS AND SHALL BE COORDINATED WITH THE FACILITY MANAGER.
58. ALL ELECTRICAL WORK IN ADJOINING AREAS WHICH IS REQUIRED TO FUNCTION BUT IS AFFECTED BY THIS WORK SHALL BE RECONNECTED AND RESTORED TO ITS PRESENT FUNCTION AS PART OF THE ELECTRICAL SYSTEM OF THE BUILDING.
59. ALL PENETRATIONS THROUGH OR CHOPPING OF FLOOR SLAB FOR ELECTRICAL INSTALLATION SHALL BE COORDINATED WITH FACILITY MANAGER. ALL WORK SHALL BE PERFORMED AFTER NORMAL BUSINESS HOURS. LOCATIONS SHALL BE LAID OUT AND CONFIRMED BY ARCHITECT PRIOR TO START OF PHYSICAL WORK.
60. ELECTRICAL CONTRACTOR SHALL OBTAIN AN "INFECTION CONTROL RISK ASSESSMENT (ICRA) FROM THE OWNER FOR INFECTION CONTROL CONSTRUCTION STANDARD PROCEDURES.
61. WHENEVER ELECTRONIC OR ADJUSTABLE CIRCUIT BREAKERS ARE PROVIDED, THE CONTRACTOR SHALL SUBCONTRACT THE SERVICES OF A QUALIFIED SWITCHBOARD MANUFACTURER TO CALCULATE THE REQUIRED TRIP COORDINATION SETTINGS INCLUDING BUT NOT LIMITED TO, THE LONG DELAY, SHORT DELAY, GROUND FAULT, PICKUP, TRIP TIMES AND SHORT CIRCUIT CURRENT, ETC... THE CONTRACTOR SHALL ALSO INCLUDE THE SERVICES OF THE MANUFACTURER'S FIELD SERVICE TECHNICIAN TO INSTALL, PROGRAM AND ADJUST THE CIRCUIT BREAKERS, PROVIDE ALL NECESSARY JUMPER CONNECTIONS, CONTROL WIRES AND MODIFICATIONS.

DRAWING LIST

- | | |
|-----------|--|
| E-001.00 | ELECTRICAL GENERAL NOTES |
| E-002.00 | ELECTRICAL SYMBOL LIST AND ABBREVIATIONS |
| E-011.00 | SECOND FLOOR POWER DEMOLITION PLAN |
| E-012.00 | SECOND FLOOR LIGHTING DEMOLITION PLAN |
| E-101.00 | SECOND FLOOR LIGHTING PLAN |
| E-201.00 | SECOND FLOOR POWER PLAN |
| E-301.00 | ELECTRICAL PANEL SCHEDULES AND RISER DIAGRAM |
| E-401.00 | ELECTRICAL DETAILS SHEET No. 1 |
| E-501.00 | ELECTRICAL DETAILS SHEET No. 2 |
| FA-001.00 | FIRE ALARM NOTES AND RISER DIAGRAM |
| FA-101.00 | SECOND FLOOR FIRE ALARM PLAN |
| EN-001.00 | ENERGY COMPLIANCE COVER SHEET |
| EN-002.00 | ENERGY COMPLIANCE DETAILS |
| EN-101.00 | SECOND FLOOR LIGHTING PLAN |

- | | |
|-----------|-------------------------------|
| EN-001.00 | ENERGY COMPLIANCE COVER SHEET |
| EN-002.00 | ENERGY COMPLIANCE DETAILS |
| EN-101.00 | SECOND FLOOR LIGHTING PLAN |

PROGRESS
11-02-2011

DOB EMPLOYEE STAMPS AND SIGNATURES

DOB BSCA
STICKER:

[illegible]

KEY PLAN :

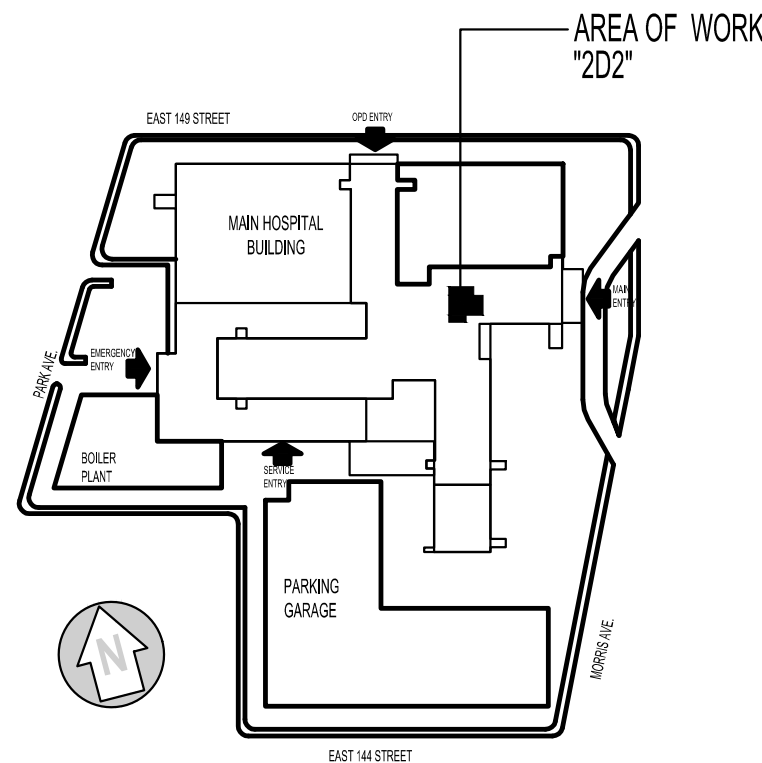

CLIENT



CLIENT

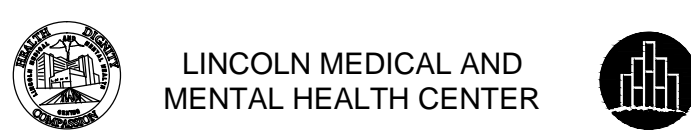

ARCHITECT:



ENVIRONMENTAL ENGINEERING CONSULTANT:



PROJECT:

NEW CLINIC RENOVATION AT SECOND FLOOR

DRAWING:

ELECTRICAL GENERAL NOTES

SCALE : NONE

CE

CHECKED BY: G

DATE: 09.06.2011

ISSN	01415-00
------	----------

DRAWING #

E-001.00

THIS PLAN IS APPROVED ONLY FOR WORK INDICATED ON THE APPLICATION SPECIFICATION SHEET. ALL OTHER MATTERS SHOWN ARE NOT TO BE RELIED UPON, OR TO BE CONSIDERED AS EITHER BEING APPROVED OR IN ACCORDANCE WITH APPLICABLE CODES.