

PANEL: LPE2-2C VOLTAGE: 277/480 VOLTS, 3ø, 4W MAIN BUS: 100 AMPS LOCATION: ELECTRICAL CLOSET ENCLOSURE: NEMA <input checked="" type="checkbox"/> 1 <input type="checkbox"/> 3R <input type="checkbox"/> 4X <input type="checkbox"/> 12 MOUNTING: <input checked="" type="checkbox"/> SURFACE <input type="checkbox"/> RECESSED	MAIN RATING: <input checked="" type="checkbox"/> XXX	<div style="border: 2px solid black; padding: 10px; display: inline-block;">         EXISTING       </div>
---	---	--

NOTE	BRANCH FEEDER	PROT. DEVICE			LOAD DESCRIPTION	øA (VA)	øB (VA)	øC (VA)	OKT	PHASE			OKT	øA (VA)	øB (VA)	øC (VA)	LOAD DESCRIPTION	PROT. DEVICE			BRANCH FEEDER	NOTE
		POLE	TRIP	FRAME						A	B	C						FRAME	TRIP	POLE		
-	-	1P	20A	100A	LTG. 2-1,12C,13C,275,375	-	-	-	1		2	-	-	-	LTG. 2-432	100A	20A	1P	-	-	-	
-	-	1P	20A	100A	LTG. 2-13,21C,34C,STAIR 3	-	-	-	3		4	-	-	-	LTG. 2-432	100A	20A	1P	-	-	-	
-	-	1P	20A	100A	LTG. 2-1C,20,30,7C,54C	-	-	-	5		6	-	-	-	LTG. 2-444,434,432	100A	20A	1P	-	-	-	
-	-	1P	20A	100A	EXIT LIGHT 2-7C,54C	-	-	-	7		8	-	-	-	LTG. 3-275	100A	20A	1P	-	-	-	
-	-	1P	20A	100A	LTG. 2-448,450,452,453	-	-	-	9		10	-	760	-	CUNIC EGRESS LTG.	100A	20A	1P	-	-	2ø12, 1ø12G - 3/4"	
-	-	1P	20A	100A	LTG. 2-6,360,350,401,415	-	-	-	11	12	-	-	-	SPARE	100A	20A	1P	-	-	-		

NOTES:

PANEL: RPE2-1G VOLTAGE: 120/208 VOLTS, 3ø, 4W MAIN BUS: 225 AMPS LOCATION: ELECTRICAL CLOSET ENCLOSURE: NEMA <input checked="" type="checkbox"/> 1 <input type="checkbox"/> 3R <input type="checkbox"/> 4X <input type="checkbox"/> 12 MOUNTING: <input checked="" type="checkbox"/> SURFACE <input type="checkbox"/> RECESSED			MAIN RATING: <input checked="" type="checkbox"/> M.L.O.			EXISTING	
---	--	--	--	--	--	----------	--

NOTE	BRANCH FEEDER	PROT. DEVICE			LOAD DESCRIPTION	øA (VA)	øB (VA)	øC (VA)	ØKT	PHASE			ØKT	øA (VA)	øB (VA)	øC (VA)	LOAD DESCRIPTION	PROT. DEVICE			BRANCH FEEDER	NOTE
		POLE	TRIP	FRAME						A	B	C						FRAME	TRIP	POLE		
	EXISTING FEEDER	1P	20A	100A	EXISTING LOAD	—	—	—	1				2	—	—	—	EXISTING LOAD	100A	20A	1P	EXISTING FEEDER	
	EXISTING FEEDER	1P	20A	100A	EXISTING LOAD	—	—	—	3				4	—	—	—	EXISTING LOAD	100A	20A	1P	EXISTING FEEDER	
	EXISTING FEEDER	1P	20A	100A	EXISTING LOAD	—	—	—	5				6	—	—	—	EXISTING LOAD	100A	20A	1P	EXISTING FEEDER	
	EXISTING FEEDER	1P	20A	100A	EXISTING LOAD	—	—	—	7				8	—	—	—	EXISTING LOAD	100A	30A	1P	EXISTING FEEDER	
	EXISTING FEEDER	1P	20A	100A	EXISTING LOAD	—	—	—	9				10	—	—	—						
	EXISTING FEEDER	1P	20A	100A	EXISTING LOAD	—	—	—	11				12	—	—	—						
	EXISTING FEEDER	2P	30A	100A	EXISTING LOAD	—	—	—	13				14	—	—	—	EXISTING LOAD	100A	20A	1P	EXISTING FEEDER	
						—	—	—	15				16	—	—	—						
	EXISTING FEEDER	2P	20A	100A	EXISTING LOAD	—	—	—	17				18	—	—	—	EXISTING LOAD	100A	20A	1P	EXISTING FEEDER	
						—	—	—	19				20	—	—	—	EXISTING LOAD	100A	20A	1P	EXISTING FEEDER	
	EXISTING FEEDER	2P	20A	100A	EXISTING LOAD	—	—	—	21				22	—	—	—						
						—	—	—	23				24	—	—	—	1000 CLINIC CRASH CART REC.	100A	20A	1P	2ø12, 1ø12G - 3/4"	
	2ø12, 1ø12G - 3/4"	1P	20A	100A	EXAM RM. 208,209,210,211	1440			25				26	—	—	—	SPARE	100A	20A	1P	—	
	2ø12, 1ø12G - 3/4"	1P	20A	100A	EXAM RM. 205,206,207		1080		27				28	—	—	—	SPARE	100A	20A	1P	—	
	2ø12, 1ø12G - 3/4"	1P	20A	100A	EXAM RM. 212,213,214			1080	29				30	—	—	—	SPARE	100A	20A	1P	—	

NOTES:



- THIS PLAN IS APPROVED ONLY FOR WORK INDICATED ON THE APPLICATION SPECIFICATION SHEET. ALL OTHER MATTERS SHOWN ARE NOT TO BE RELIED UPON, OR TO BE CONSIDERED AS EITHER BEING APPROVED OR IN ACCORDANCE WITH APPLICABLE CODES.

**PROGRESS**  
**11-02-2011**

KEY PLAN :

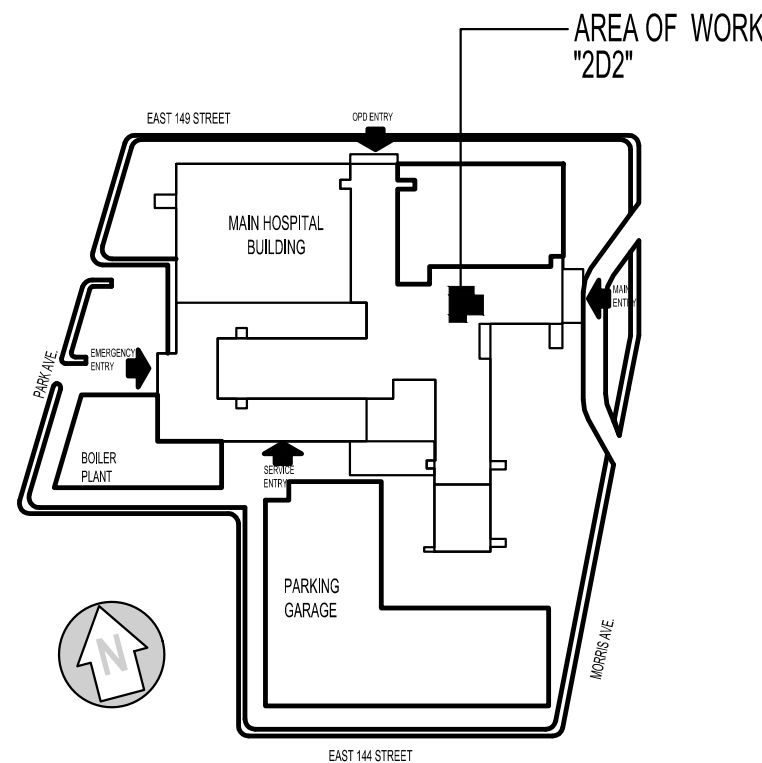

PROJECT: NEW CLINIC RENOVATION AT SECOND FLOOR

SCALE : NONE		DRAWING # :
DRAWN BY : CP		<b>E-301.00</b>
CHECKED BY : GA		
DATE : 09-06-2011		
JOB # : 21115.00		